

❶ Specifying the fan drill hole

Exact positioning is only necessary if the sanitary sewage tank is located far to the front in the service compartment, as shown in the figure, in order to ensure that the service door closes correctly.

If more space is available, the fan can also be positioned somewhat higher or lower.

For exact positioning, place a ruler (flat material) on the sanitary sewage tank ❶ with the cartridge inserted.

Measure the height from the base to the upper edge of the flat material.

Close the service door, transfer the measured height onto the middle of the door, measure from the point 20 mm to the top and drawn on. This point is the center of the hole.

Drill the hole in the door with a pot drill or hole milling device: 36-37 mm diameter.

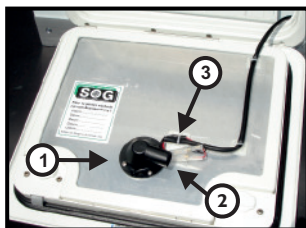
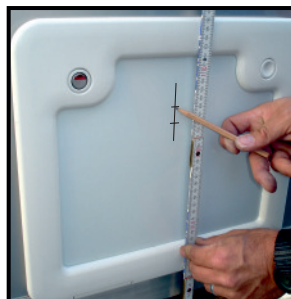

❷ Inserting the fan

As odors can penetrate through unsealed points into the service compartment and from there into the vehicle, a careful **SEALING** is important:

Grease drill hole with silicone; Insert fan ❶, the hose connection in the fan ❷ must ideally point in the opposite direction to the SOG connection in the cover.

Fasten fan with the screws 3.5 x 16 mm (4 items).

Attach cable cap ❸ 25 x 25 mm below the fan for strain relief.

Attach two further adhesive caps and lay the cable as shown in the figure.

❸ Mounting the filter housing



Apply a silicone beading on the rear of the filter housing around the fan outlet opening.



Mount the filter housing in the center of the frame recess for reasons of visual appearance.

Screw screws, 3.5 x 16 mm VA, into the aluminium sheet without drilling beforehand and tighten. If a metal sheet is to be used here, pre-drill with 3mm.



Insert filter in the available fixture.



Place cover on the top - pull it forwards slightly at the bottom. Push the cover from top to bottom so that it locks into place. Screw in screws and tighten slightly. Apply a light pressure on the cover while doing so.

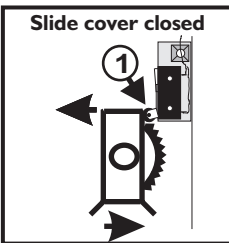
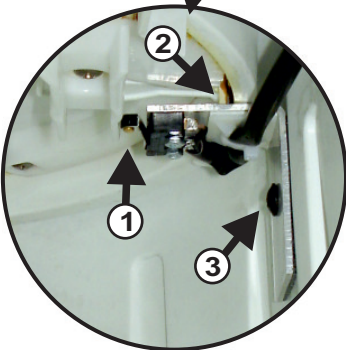
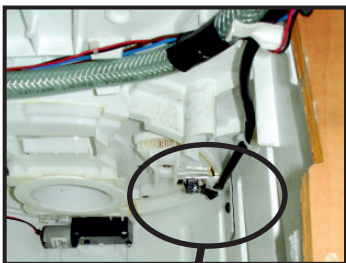
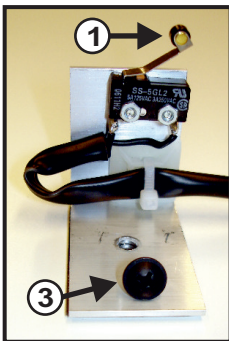

4 Electrical installation

4.1 Stick Aluminium bracket:

Before sticking, clean the mounting surface on the sheet metal wall with methylated spirit.

Pull off adhesive foil protection to stick the aluminum bracket with the micro-switch.

The aluminum bracket must be bonded in so that the guide roller ① of the micro-switch is located on the rear edge of the slider opening bar.

The upper horizontal limb of the aluminium bracket must be on the plastic housing ②.

NOTE: The power supply is interrupted when the switch is pressed down, with the result that the fan is only switched on when the slider is open.

The aluminum bracket must also be secured with the Phillips screw ③ 3.9 x 9.5. Screw the Phillips screw out through the 5 mm hole of the service compartment with a cordless screwdriver without pre-drilling. This is possible because the plastic wall is double-sided.

ATTENTION: do not use a longer screw.

4.2 Cable harness laying:

Shorten the cable harness to the required length and fasten with the cable clips and self-adhesive caps provided.

The supply line to the toilet is located in the service compartment at the bottom right (cable colours: black, red, purple, grey). "plus" and "minus" can be discerned from the colours black and red. As a rule, red is at "plus" and black at "Ground". (but check polarity)

Connect cable to the branch connectors provided (red), connect the red cable of the cable harness to "red", and the black cable of the cable harness to "black".

4.3 Functional test - checking the connections:

Open the blade valve and the ventilator should run. If it does not run check that the 12 V caravan supply is switched on.

On a number of vehicles the toilet is connected to the water pressure pump then switch on the water pressure pump.

If the ventilator still does not work, check the polarity as the ventilator has reverse polarity protection and only runs with correct „plus“ and „minus“ connections.

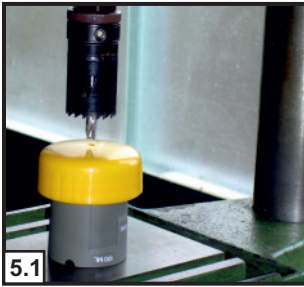

⑤ Establish hose connection at the cassette

In order to establish the hose connection on the cassette, the screw cover must be drilled on at the outlet pipe.

5.1 Place screw cover on drill table and drill on with pot drill 35 mm diameter. Drill with the centering drill in the recess of the cover - when drilling through the measuring beaker will loosen - remove this and put the cover on again.

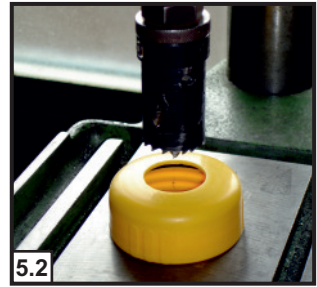

5.2 Drill cover on 35 mm diameter.

5.3 Insert lead-through rubber into drill hole.

5.4 Moisten lead-through rubber and insert connecting sleeve into the rubber, pushing in as far as the limit stop.

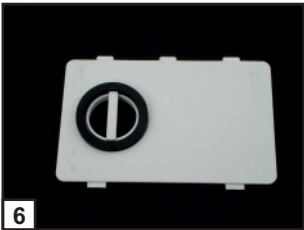

⑥ Remove insertion plate in the service compartment

(place in vehicle with the customer documentation)

The ventilation valve in the cartridge is opened via the central web in the drill hole. This must always be prevented when using a SOG ventilation; the ventilation valve must always remain closed (gas escape).

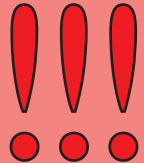

⑦ Adjusting the air outlet hose:

- Insert the hose in the cover connection and shorten to the required length. The service door should be suspended all the way down.
- Now pull out from the connection again and screw the hose counter clockwise onto the fan housing connection.
- The hose must not be fastened with a cable clip or similar fastening clips, as this would irreparably damage the fan.
- Close the service door and ensure that the hose is neatly inserted and no siphon forms.
- The hose is removed from the cartridge at the cover connection and sealed with the enclosed plugs during emptying.

⑧ Functional test of the ventilation system - Mandatory

Open the blade valve and hold a burning incense (joss) stick or cigarette above it. If the smoke is drawn down into the holding tank the ventilation system is working correctly.